

Electrically height-adjustable special work table for clamping tasks – Size L

Electrically height-adjustable special work table with side bolsters of the SWT E-FLEX series with Ø28 perforation system for holding System 28 clamping tools for fixing workpieces, constructions, tools as well as small processing devices or clamping plates. This height-adjustable version offers an electrohydraulically adjustable single-scissor table frame for stepless adjustment of the optimal ergonomic working height or for height adjustment when used on other work surfaces, machines and systems in use e.g. For example, as a side or feed table. Unlike s.g. Lift tables that are designed and intended for lifting and lowering loads and people have height-adjustable special work tables with rigid functional work and clamping plates, the height of which can be set according to the work task.

Examples of use:

Metal construction - height adjustable 3D welding table for tensioning welded constructions
Woodworking
Height-adjustable work table for tensioning glue structures
Mechanical engineering - dressing table f. Individual parts, assembly work station with flexible working height
Toolmaking - Securing and clamping even stationary tool parts at an optimal working height for internal transport
Industry in general - ergonomic and mobile maintenance work station, support for clamping devices with height adjustment

	SWT E 35-105/16-200 L	SWT E 65-105/16-200 L
Table top dimensions	2980 x 1480(mm)	2980 x 1480(mm)
Thickness of the table top dual	16mm	16mm
Height of side panel	200mm	200mm
Material of tabletop	See table below	See table below
Diameter of holes at tabletop	Ø 28mm	Ø 28mm
Hole grid	100 x 100(mm)	100 x 100(mm)
Variable height	350 x 1050(mm)	650 x 1050(mm)
Lifting capacity	250kg	250kg
Max. load	2000kg	2000kg
Net weight	977kg	953kg

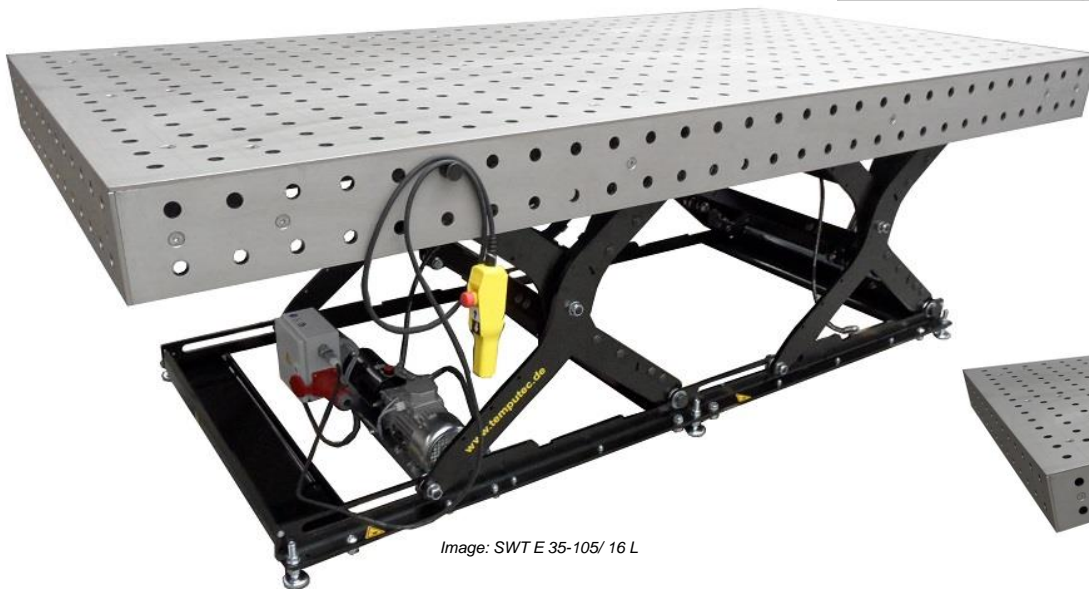

Image: SWT E 35-105/ 16 L



Image: SWT E 35-105/ 16 L lower position

Tabletop

Description

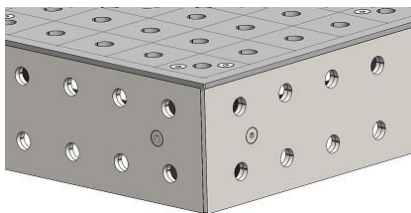

Tabletop build as a dual plate system with upper plate, lower plate and support construction of 2 beams lengthwise and 4 cross beams achieving flatness acc. workstandard WN5110000 in dependance upon DIN ISO 2768-2. The 4-side 200mm side panels with hold grid enables the setting of stops, vertical clamping or table square enlargement due to the use of sidly mounted vertical angels. The dual plate design enables the use of different surface materials which can be chosen in accordance with the working task (see table materials). In standard top plate is made from material S355 (lower plate standard S235). The surface is carrying a Ø28mm hole grid 100x100mm which allows the usage of various clamping tools (available clamping tools can be selected in our website www.temputec.de). At the top plate surface also a line grid is engraved in order to assist visual orientation.

Due to the use of two 8mm plates in dual design the optimal thickness of the top plate is 16mm.

Material of top plate of tabletop	Opt. material description	Tensile strenght MPa	Hardness HV / (HBA)	Type no. SWT E 35-105/16-200 L	Type no. SWT E 65-105/16-200 L
Regular steel ST52	S355, 1.0976	Rm 430-550	ca. 175 (128-163)	3E0457	1E0457
Higher strenght steel ST70	S700, 1.8974	Rm 780-950	ca. 265 (220-280)	3E0460	1E0460
Stainless steel	304, 1.4301,Niro	Rm 500-700	ca. 205 (150-200)	3E0463	1E0463
Other materials for special requirements	For example: Aluminium, electrical insulating Materials for electrical installations				

Electrically height-adjustable special work table for clamping tasks – Size L

Table base

Description



Image above: Scissor table base TGXX 35-105



Image above: Scissor table base TGXX 65-105

Scissor table frames in extremely robust full steel design with approx. 300 kg dead weight and 2500 kg nominal static load. Floor rail with 3 leveling feet each to compensate for uneven floors up to 5cm at the installation site. The basic height of the adjustable frames guarantees, depending on the type, working heights of min. 300mm or 650mm.

The height is adjusted by an electro-hydraulic actuator which is controlled via a cable remote control. Depending on the version, the power transmission of the height adjustment is carried out by 1 to 2 single-stage hydraulic cylinders to a max. adjustable height of the work surface of 1050mm.

The height of the SWT worktop is fully adjustable from 350mm to 1050mm with a fully screwed double scissor table frame. These frames have 2-4 supporting hydraulic cylinders.

Details on the purpose of use as well as on operation and maintenance can be found in the corresponding operating instructions for the respective model. For pure lifting devices according to EN1570, please inquire alternatively about lifting frames for lifting and lowering load carriers or platforms.

As standard, the adjustable table frame in black RAL 9005 (KTL or powder) is long-lasting coated. The frame is also available individually with prefabricated adapters for the construction of customer-specific structures (see www.temputec.de)

E-FLEX Hydraulics

Description



In contrast to the manually adjustable table systems of the FLEX series, E-FLEX models have an electro-hydraulic drive. The movement dynamics is mechanically reduced to 15mm / s to safe speed. A modular built-in compact unit with an oil volume of up to 4 liters enables the operation of up to 4 hydraulic cylinders for height adjustment. The E-FLEX hydraulics is operated via a switch box with switch control and power connection socket 380 / 400V. The system design offers at least protection IP44. The height adjustment is carried out via a cable remote control with 3 control buttons (UP-DOWN and emergency-OFF) made of shockproof polypropylene of protection class IK08 acc. EN50102 controlled. The 3m long connecting cable of the cable remote control is detachably connected to a lockable socket and can be removed by the installer after the setting process.

Hydraulic unit	Standard version
Compact unit dead weight	12 kg
Motor protection class	IP55 , CE
Motor operating voltage	380 / 400V, 50-60Hz
Motor power consumption	1,5 - 2,6A AC
Engine power	0,55 - 0,75 KW
Engine speed	bis 1.400 rpm
Motor power factor cos ϕ	0,75
Pump principle	gear
Funding volume	0,5-2,3 cm ³ /U
Pressure (nom./max)	150 / 230 bar
Tank capacity	0,5-4,0 Liter
Fluid viscosity	46 mm ² /s

The E-FLEX hydraulics can also be modularly retrofitted to manually adjustable systems of the FLEX series in just a few steps. Additional information can be found in the respective operating instructions for the relevant models.